

Efasadi RerZebSi A - B 1:50
Elevation North 1:50

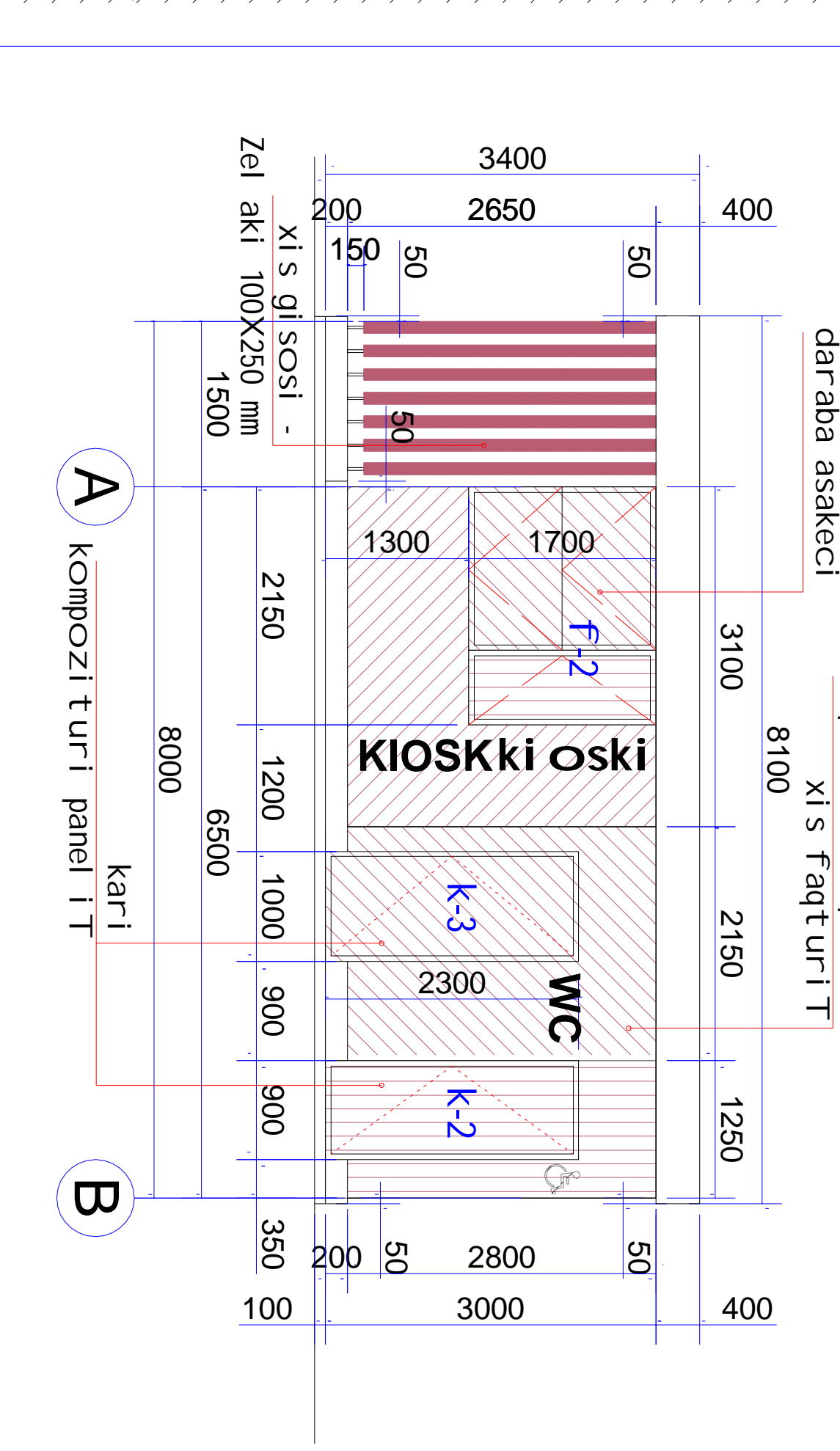

Efasadi RerZebSi B - A 1:50
Elevation South 1:50

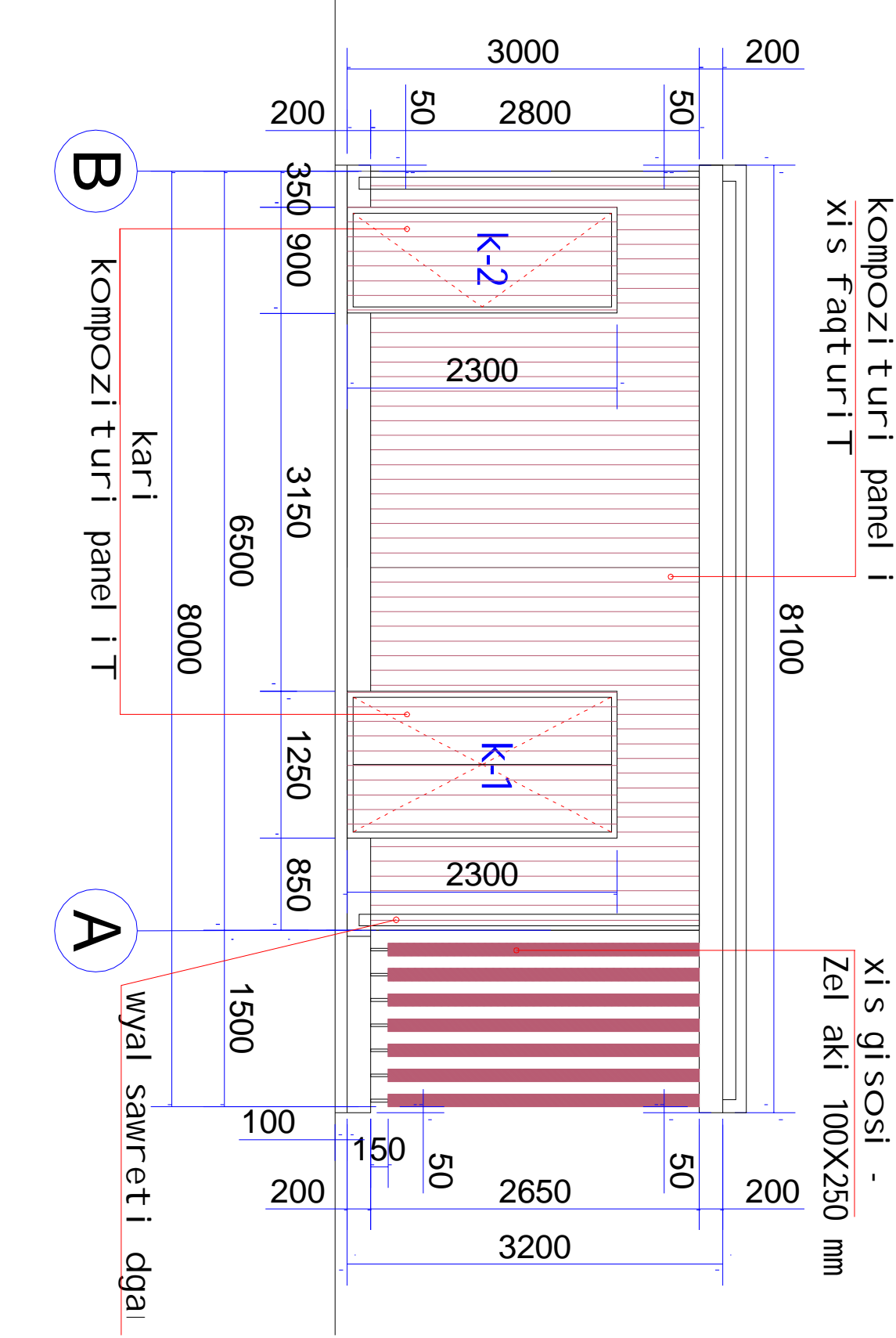

Efasadi RerZebsi 1 - 2 1:50
Elevation West 1:50

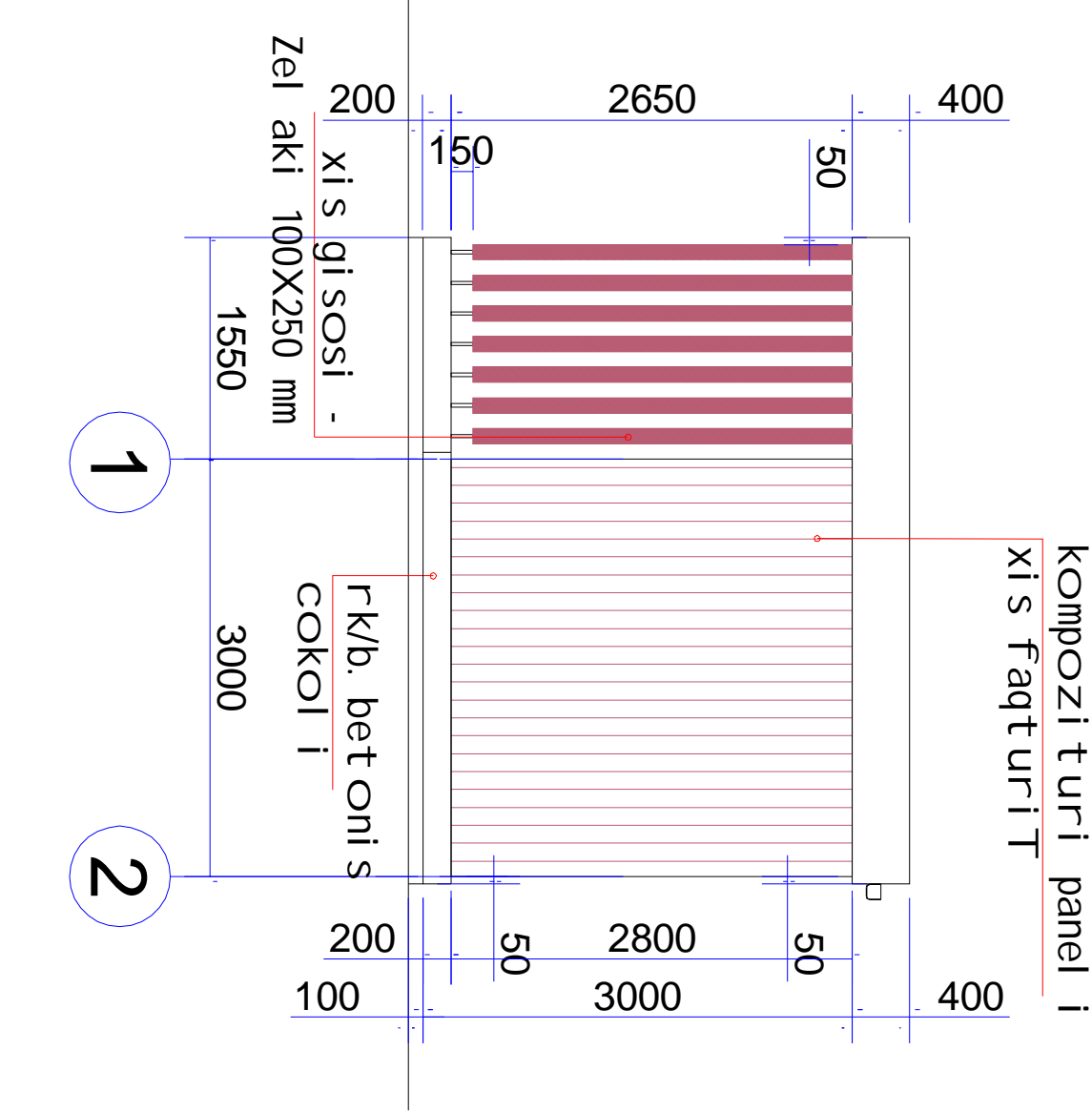

Efasadi RerZebSi 2 - 1 1:50
Elevation East 1:50

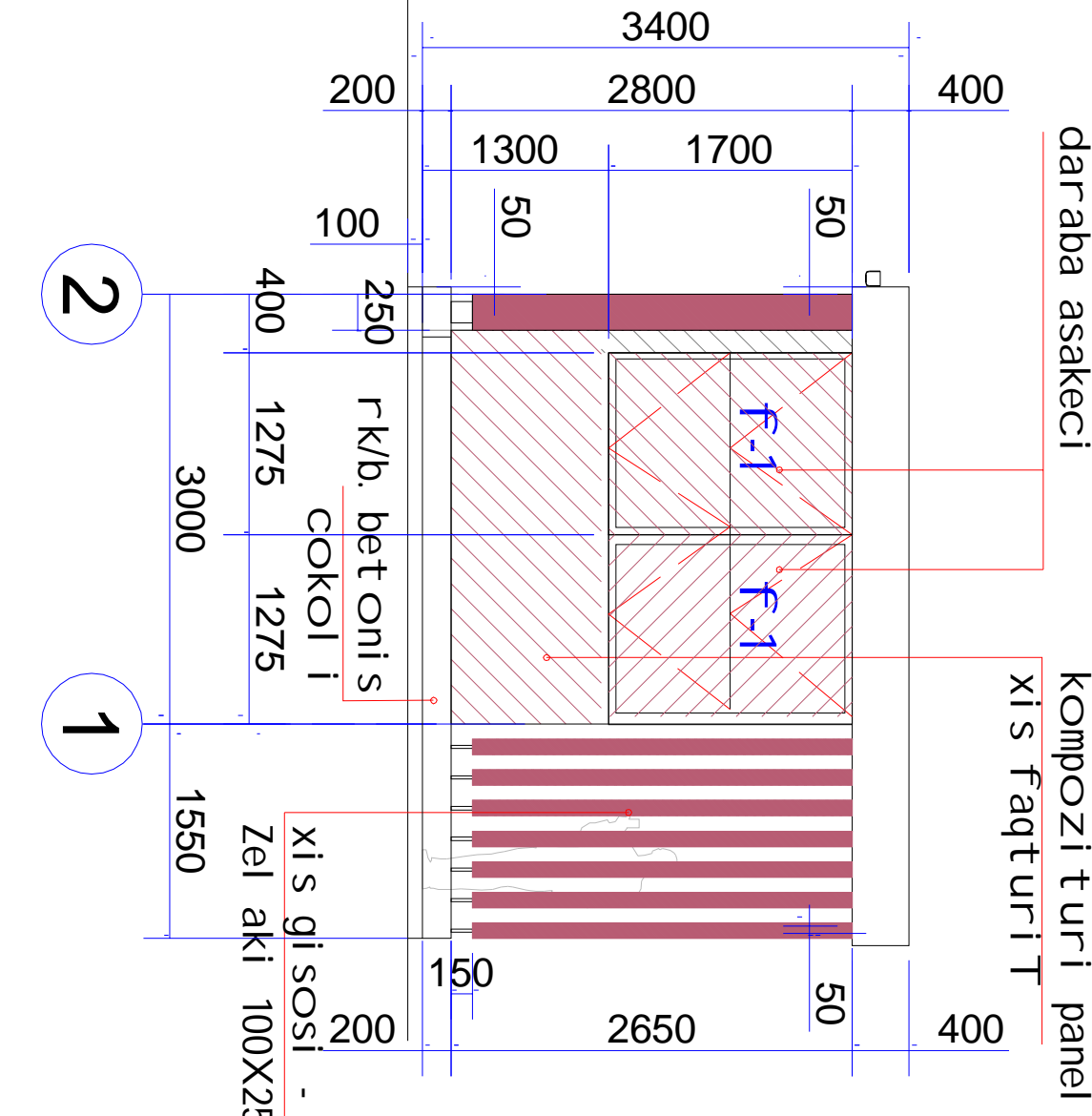

Wri i 1 - 1. 1:50
Section 1-1' 1:50

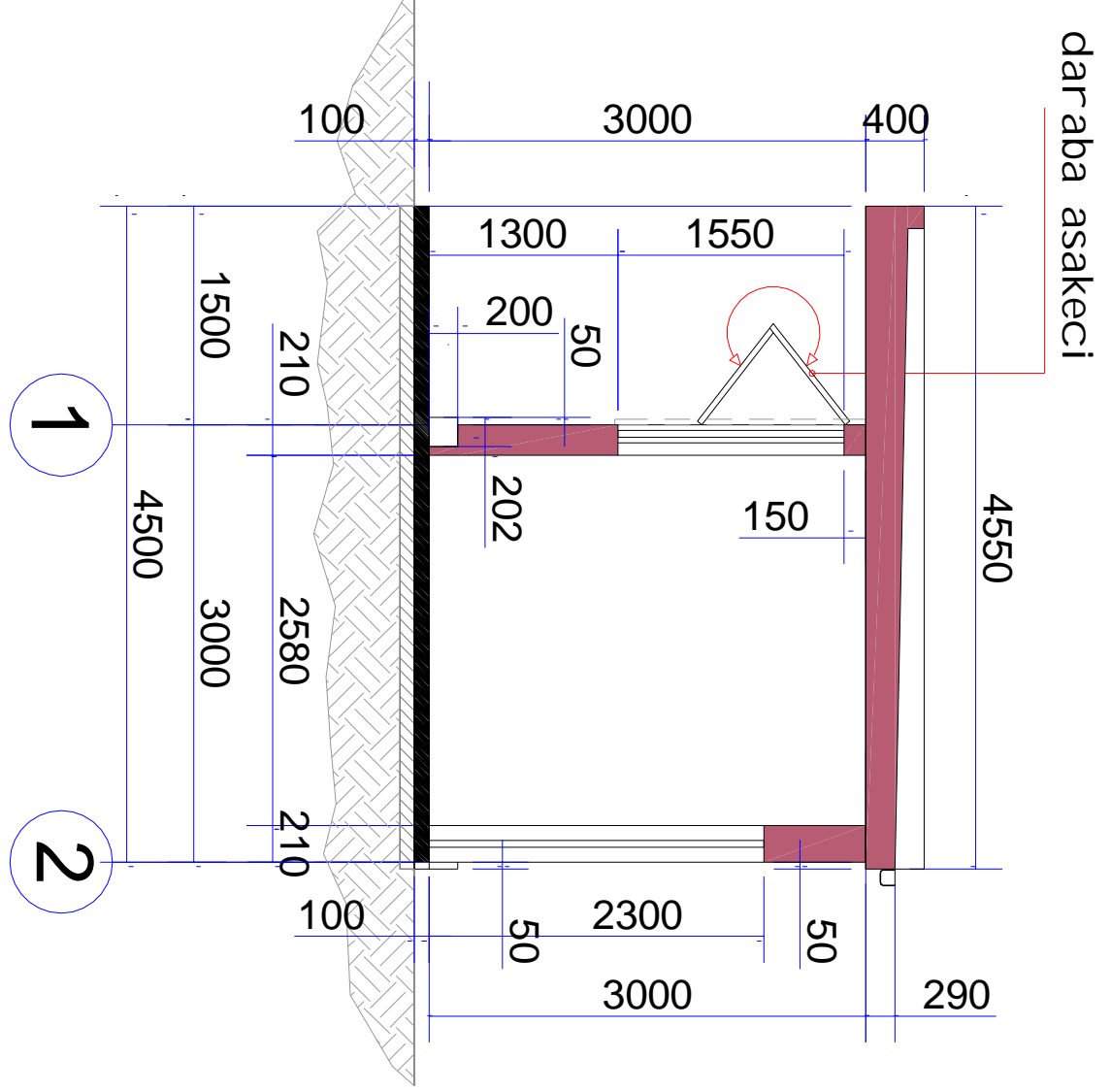

K2 ki oski . mosacdel i ; samzareul o ; tual etebi ; daml agebl i s oTax



2. ki oski (samzareul o)
3. tual eti
4. Ssm tual eti
5. daml agebl is OTaxi

Plan 1:50

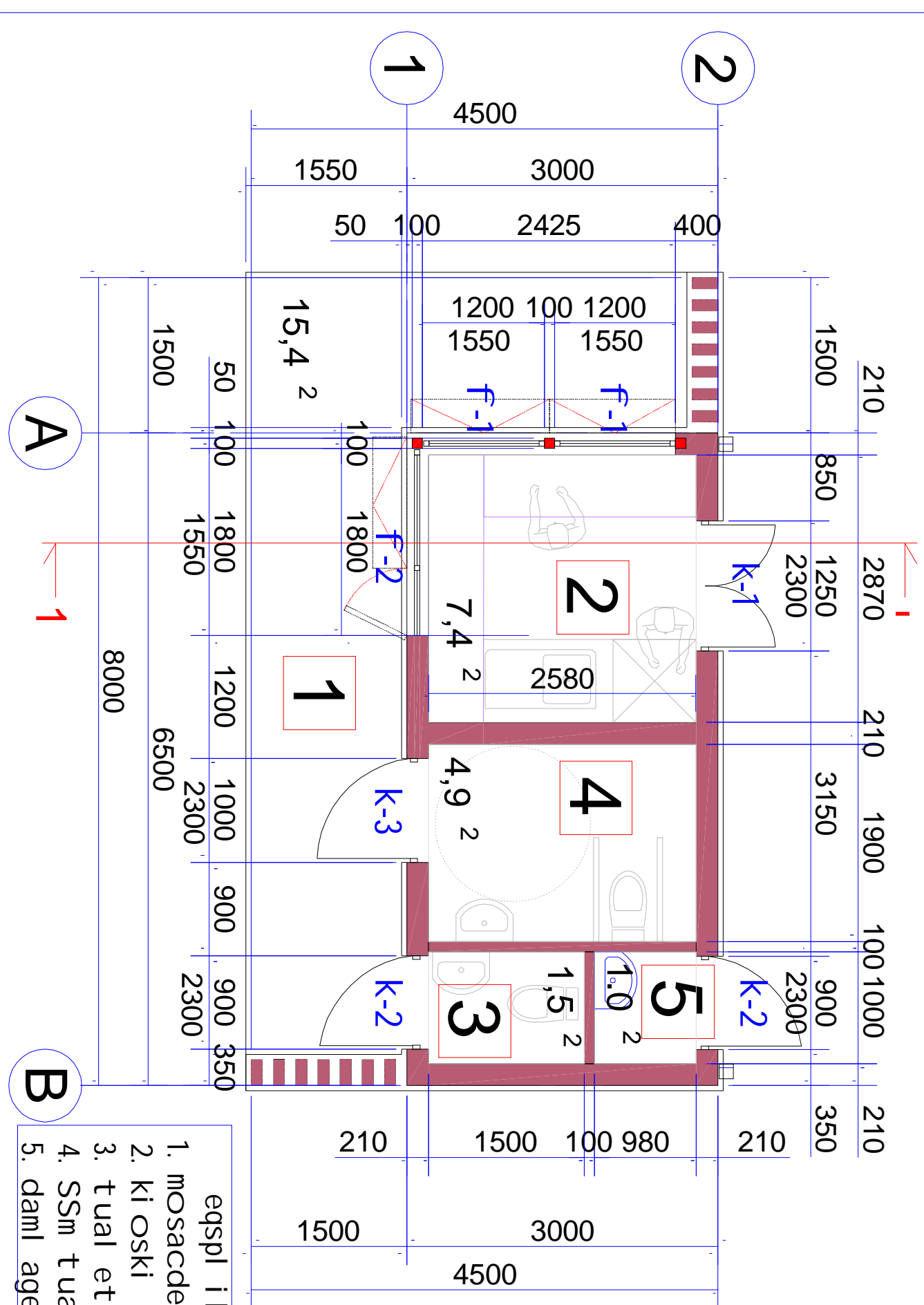

saxuravi s Egegma 1:50
dgari
Roof Plan 1:50

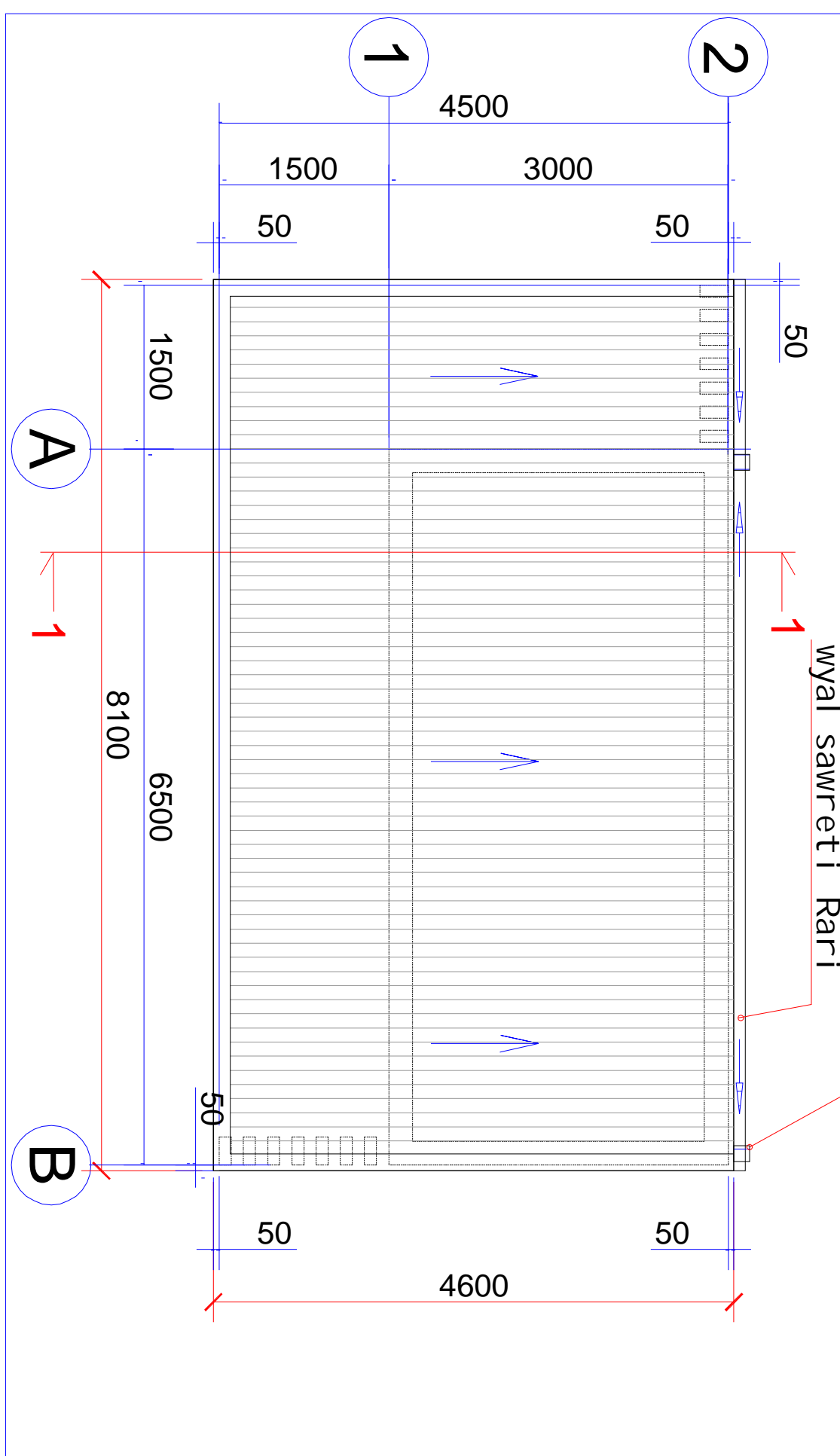

betonis cokol is dakval vis gegma 1:50
xis dgarebi s ganl agebi s sqema

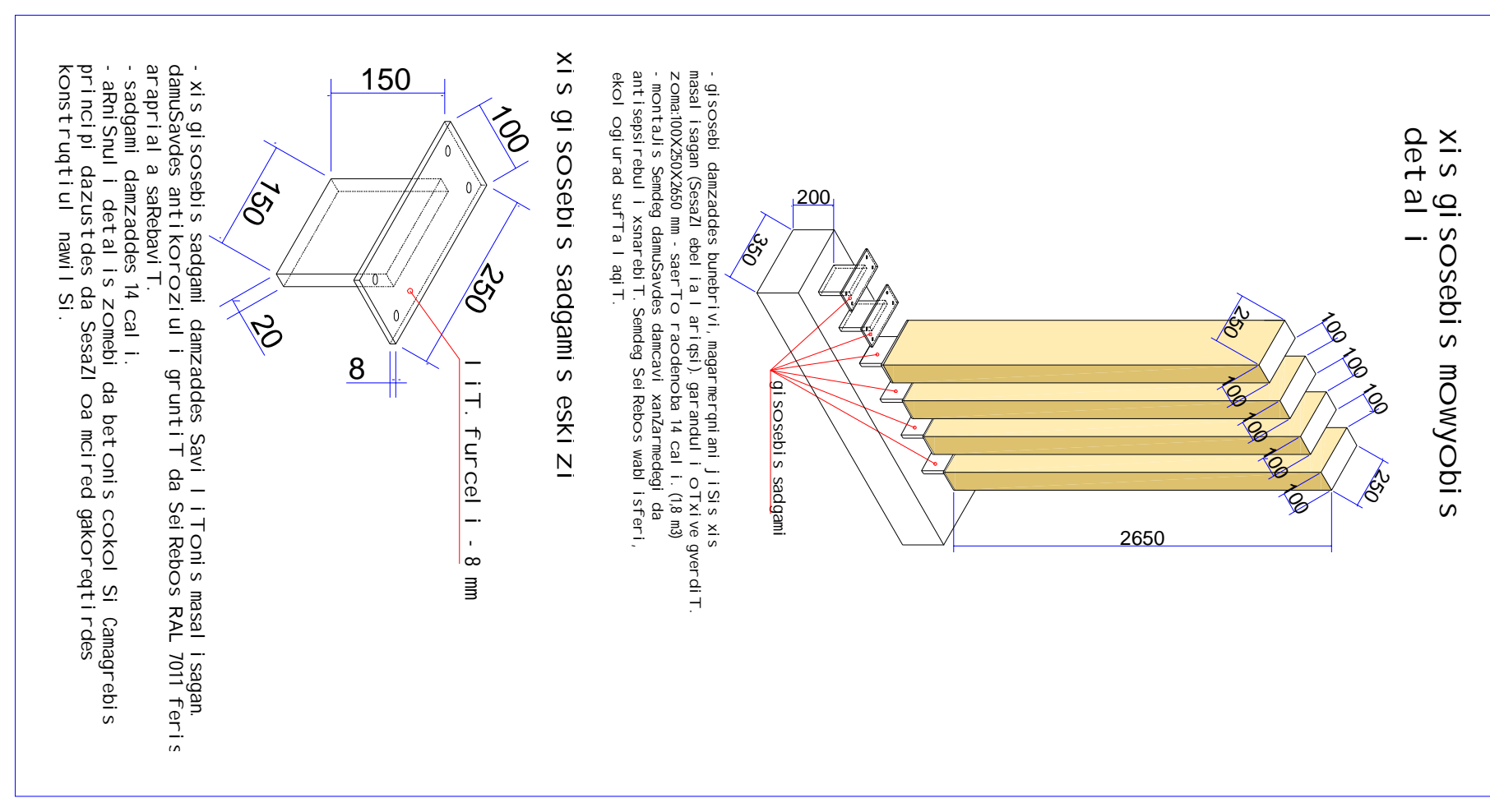
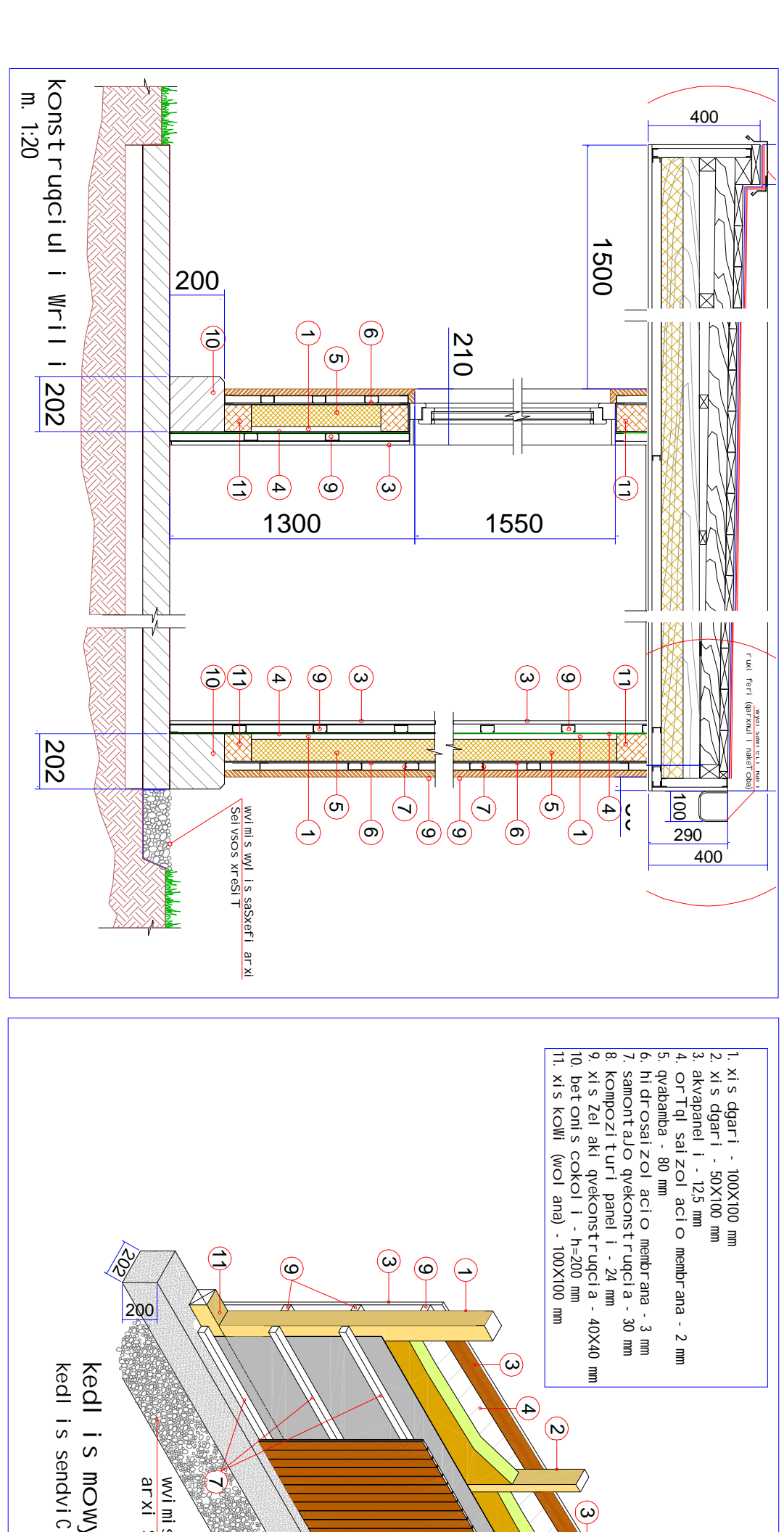
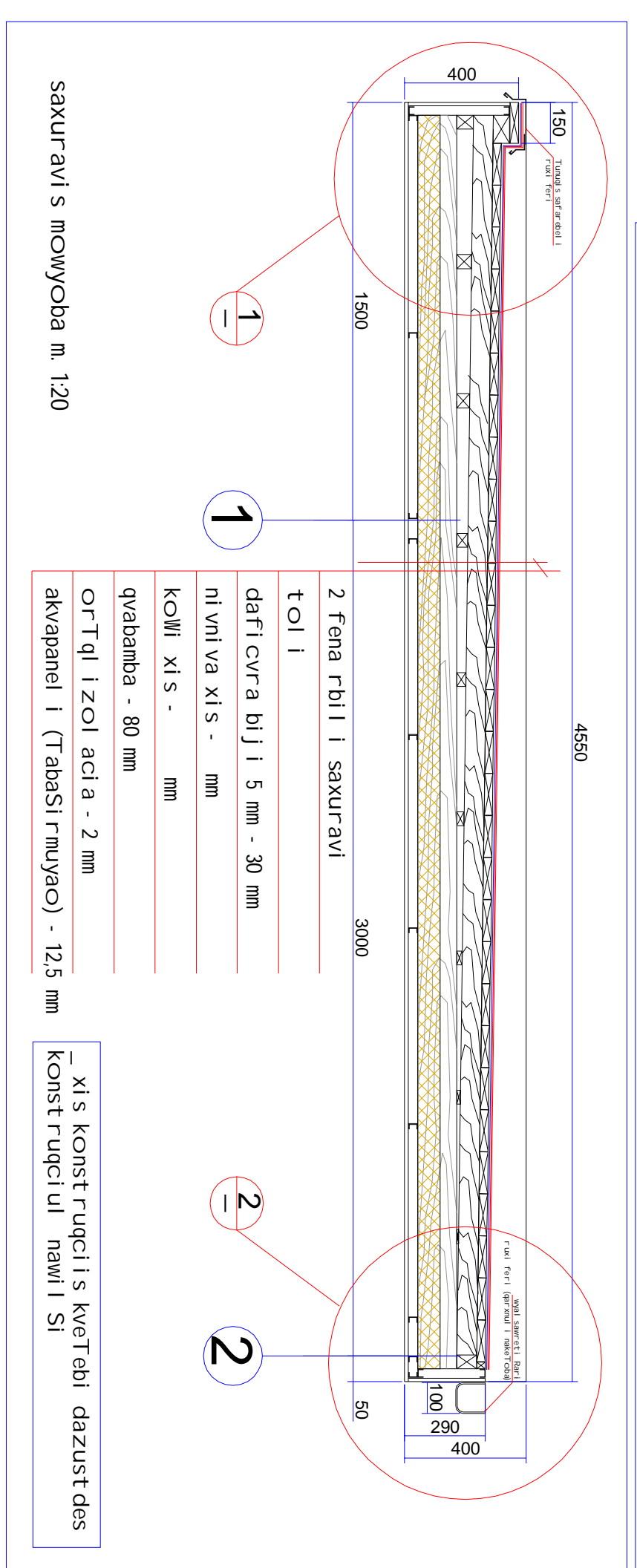
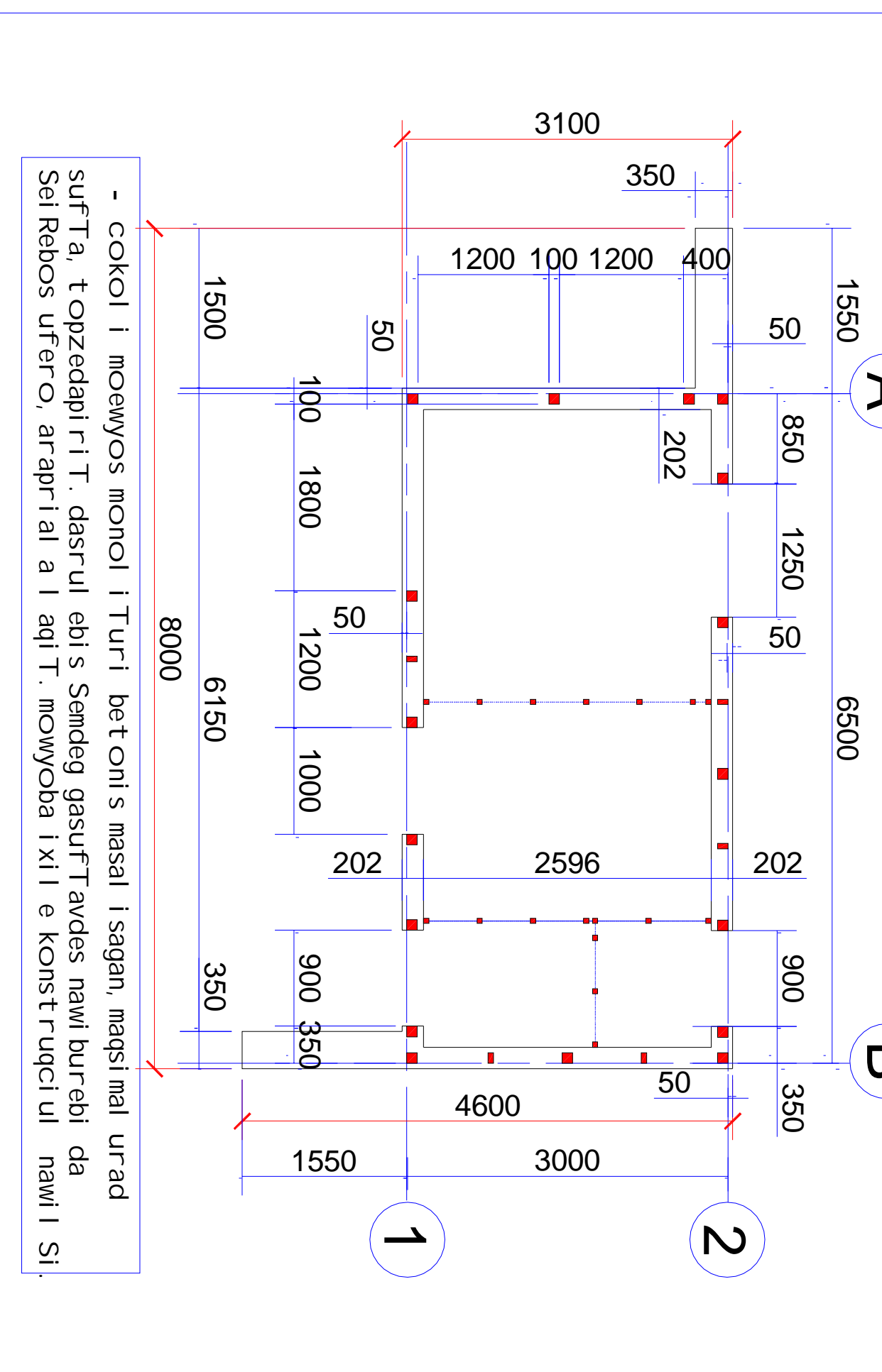

Test	i atakohi				Kodi ehi da ti xebi				Mer ehi				Semi Sama		
Set rows dataset ebia	Set rows dataset ebia	Set rows dataset ebia	Set rows dataset ebia	Set rows dataset ebia	Set rows dataset ebia	Set rows dataset ebia	Set rows dataset ebia	Set rows dataset ebia	Set rows dataset ebia	Set rows dataset ebia	Set rows dataset ebia	Set rows dataset ebia	Set rows dataset ebia	Set rows dataset ebia	Set rows dataset ebia
1	1	2	3	4	5	6	7	8	9	10	11	12	13	14	
2	1	2	3	4	5	6	7	8	9	10	11	12	13	14	
3	1	2	3	4	5	6	7	8	9	10	11	12	13	14	
4	1	2	3	4	5	6	7	8	9	10	11	12	13	14	
5	1	2	3	4	5	6	7	8	9	10	11	12	13	14	
6	1	2	3	4	5	6	7	8	9	10	11	12	13	14	
7	1	2	3	4	5	6	7	8	9	10	11	12	13	14	
8	1	2	3	4	5	6	7	8	9	10	11	12	13	14	
9	1	2	3	4	5	6	7	8	9	10	11	12	13	14	
10	1	2	3	4	5	6	7	8	9	10	11	12	13	14	
11	1	2	3	4	5	6	7	8	9	10	11	12	13	14	
12	1	2	3	4	5	6	7	8	9	10	11	12	13	14	
13	1	2	3	4	5	6	7	8	9	10	11	12	13	14	
14	1	2	3	4	5	6	7	8	9	10	11	12	13	14	
15	1	2	3	4	5	6	7	8	9	10	11	12	13	14	
16	1	2	3	4	5	6	7	8	9	10	11	12	13	14	
17	1	2	3	4	5	6	7	8	9	10	11	12	13	14	
18	1	2	3	4	5	6	7	8	9	10	11	12	13	14	
19	1	2	3	4	5	6	7	8	9	10	11	12	13	14	
20	1	2	3	4	5	6	7	8	9	10	11	12	13	14	
21	1	2	3	4	5	6	7	8	9	10	11	12	13	14	
22	1	2	3	4	5	6	7	8	9	10	11	12	13	14	
23	1	2	3	4	5	6	7	8	9	10	11	12	13	14	
24	1	2	3	4	5	6	7	8	9	10	11	12	13	14	
25	1	2	3	4	5	6	7	8	9	10	11	12	13	14	
26	1	2	3	4	5	6	7	8	9	10	11	12	13	14	
27	1	2	3	4	5	6	7	8	9	10	11	12	13	14	
28	1	2	3	4	5	6	7	8	9	10	11	12	13	14	
29	1	2	3	4	5	6	7	8	9	10	11	12	13	14	
30	1	2	3	4	5	6	7	8	9	10	11	12	13	14	
31	1	2	3	4	5	6	7	8	9	10	11	12	13	14	
32	1	2	3	4	5	6	7	8	9	10	11	12	13	14	
33	1	2	3	4	5	6	7	8	9	10	11	12	13	14	
34	1	2	3	4	5	6	7	8	9	10	11	12	13	14	
35	1	2	3	4	5	6	7	8	9	10	11	12	13	14	
36	1	2	3	4	5	6	7	8	9	10	11	12	13	14	
37	1	2	3	4	5	6	7	8	9	10	11	12	13	14	
38	1	2	3	4	5	6	7	8	9	10	11	12	13	14	
39	1	2	3	4	5	6	7	8	9	10	11	12	13	14	
40	1	2	3	4	5	6	7	8	9	10	11	12	13	14	
41	1	2	3	4	5	6	7	8	9	10	11	12	13	14	
42	1	2	3	4	5	6	7	8	9	10	11	12	13	14	
43	1	2	3	4	5	6	7	8	9	10	11	12	13	14	
44	1	2	3	4	5	6	7	8	9	10	11	12	13	14	
45	1	2	3	4	5	6	7	8	9	10	11	12	13	14	
46	1	2	3	4	5	6	7	8	9	10	11	12	13	14	
47	1	2	3	4	5	6	7	8	9	10	11	12	13	14	
48	1	2	3	4	5	6	7	8	9	10	11	12	13	14	
49	1	2	3	4	5	6	7	8	9	10	11	12	13	14	
50	1	2	3	4	5	6	7	8	9	10	11	12	13	14	
51	1	2	3	4	5	6	7	8	9	10	11	12	13	14	
52	1	2	3	4	5	6	7	8	9	10	11	12	13	14	
53	1	2	3	4	5	6	7	8	9	10	11	12	13	14	
54	1	2	3	4	5	6	7	8	9	10	11	12	13	14	
55	1	2	3	4	5	6	7	8	9	10	11	12	13	14	
56	1	2	3	4	5	6	7	8	9	10	11	12	13	14	
57	1	2	3	4	5	6	7	8	9	10	11	12	13	14	
58	1	2	3	4	5	6	7	8	9	10	11	12	13	14	
59	1	2	3	4	5	6	7	8	9	10	11	12	13	14	
60	1	2	3	4	5	6	7	8	9	10	11	12	13	14	
61	1	2	3	4	5	6	7	8	9	10	11	12	13	14	
62	1	2	3	4	5	6	7	8	9	10	11	12	13	14	
63	1	2	3	4	5	6	7	8	9	10	11	12	13	14	
64	1	2	3	4	5	6	7	8	9	10	11	12	13	14	
65	1	2	3	4	5	6	7	8	9	10	11	12	13	14	
66	1	2	3	4	5	6	7	8	9	10	11	12	13	14	
67	1	2	3	4	5	6	7	8	9	10	11	12	13	14	
68	1	2	3	4	5	6	7	8	9	10	11	12	13	14	
69	1	2	3	4	5	6	7	8	9	10	11	12	13	14	
70	1	2	3	4	5	6	7	8	9	10	11	12	13	14	
71	1	2	3	4	5	6	7	8	9	10	11	12	13	14	
72	1	2	3	4	5	6	7	8	9	10	11	12	13	14	
73	1	2	3	4	5	6	7	8	9	10	11	12	13	14	
74	1	2	3	4	5	6	7	8	9	10	11	12	13	14	
75	1	2	3	4	5	6	7	8	9	10	11	12	13	14	
76	1	2	3	4	5	6	7	8	9	10	11	12	13	14	
77	1	2	3	4	5	6	7	8	9	10	11	12	13	14	
78	1	2	3	4	5	6	7	8	9	10	11	12	13	14	
79	1	2	3	4	5	6	7	8	9	10	11	12	13	14	
80	1	2	3	4	5	6	7	8	9	10	11	12	13	14	
81	1	2	3	4	5	6	7	8	9	10	11	12	13	14	
82	1	2	3	4	5	6	7	8	9	10	11	12	13	14	
83	1	2	3	4	5	6	7	8	9	10	11	12	13	14	
84	1	2	3	4	5	6	7	8	9	10	11	12	13	14	
85	1	2	3	4	5	6	7	8	9	10	11	12	13	14	
86	1	2	3	4	5	6	7	8	9	10	11	12	13	14	
87	1	2	3	4	5	6	7	8	9	10	11	12	13	14	
88	1	2	3	4	5	6	7	8	9	10	11	12	13	14	
89	1	2	3	4	5	6	7	8	9	10	11	12	13	14	
90	1	2	3	4	5	6	7	8	9	10	11	12	13	14	
91	1	2	3	4	5	6	7	8	9	10	11	12	13	14	
92	1	2	3	4	5	6	7	8	9	10	11	12	13	14	
93	1	2	3	4	5	6	7	8	9	10	11	12	13	14	
94	1	2	3	4	5	6	7	8	9	10	11	12	13	14	
95	1	2	3	4	5	6	7	8	9	10	11	12	13	14	
96	1	2	3	4	5	6	7	8	9	10	11	12	13	14	
97	1	2	3	4	5	6	7	8	9	10	11	12	13	14	
98	1	2	3	4	5	6	7	8	9	10	11	12	13	14	
99	1	2	3	4	5	6	7	8	9	10	11	12	13	14	
100	1	2	3	4	5	6	7	8	9	10	11	12	13	14	

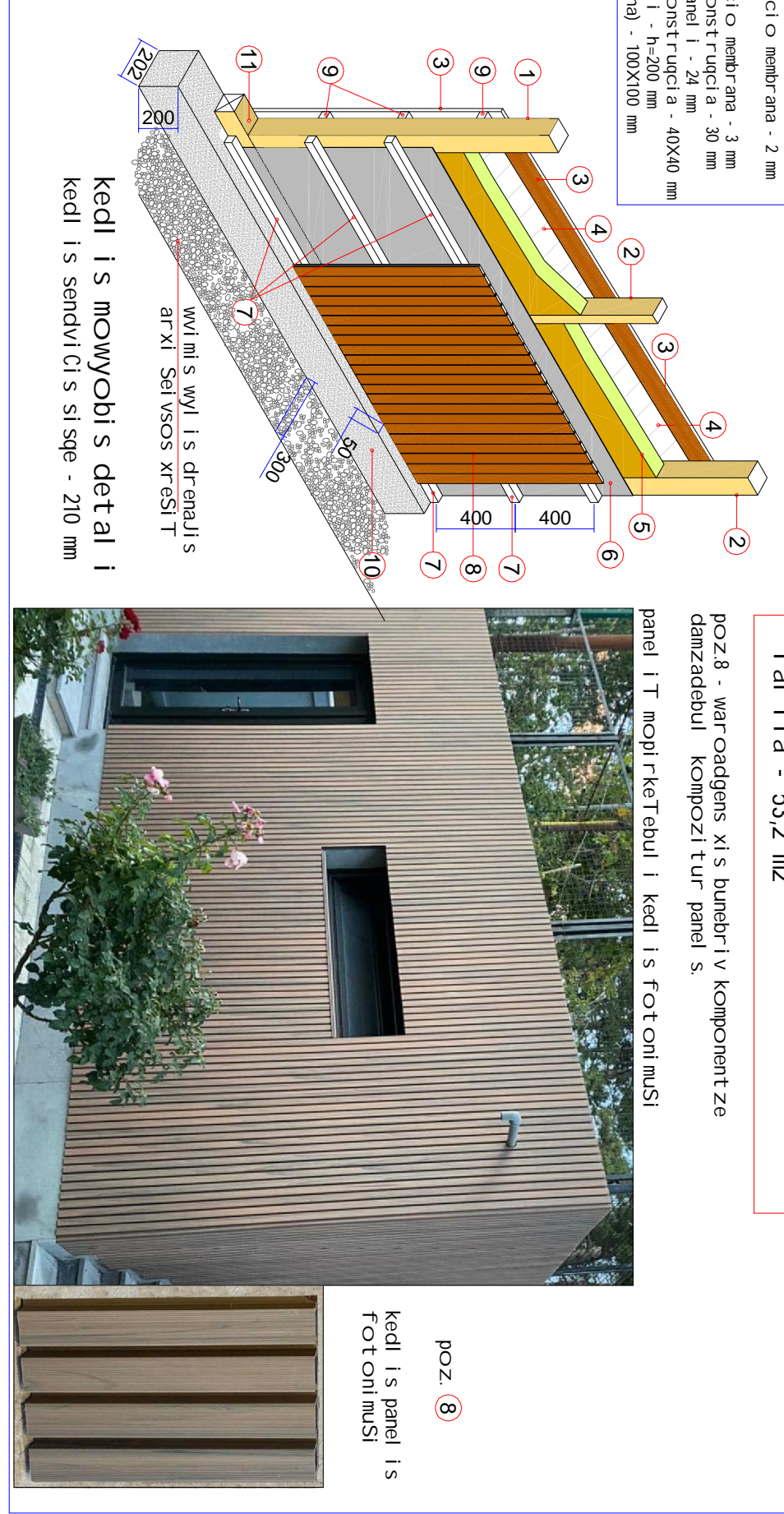

K2 Senobis fasadis mosapir ketebel i kompozituri panel is saprento

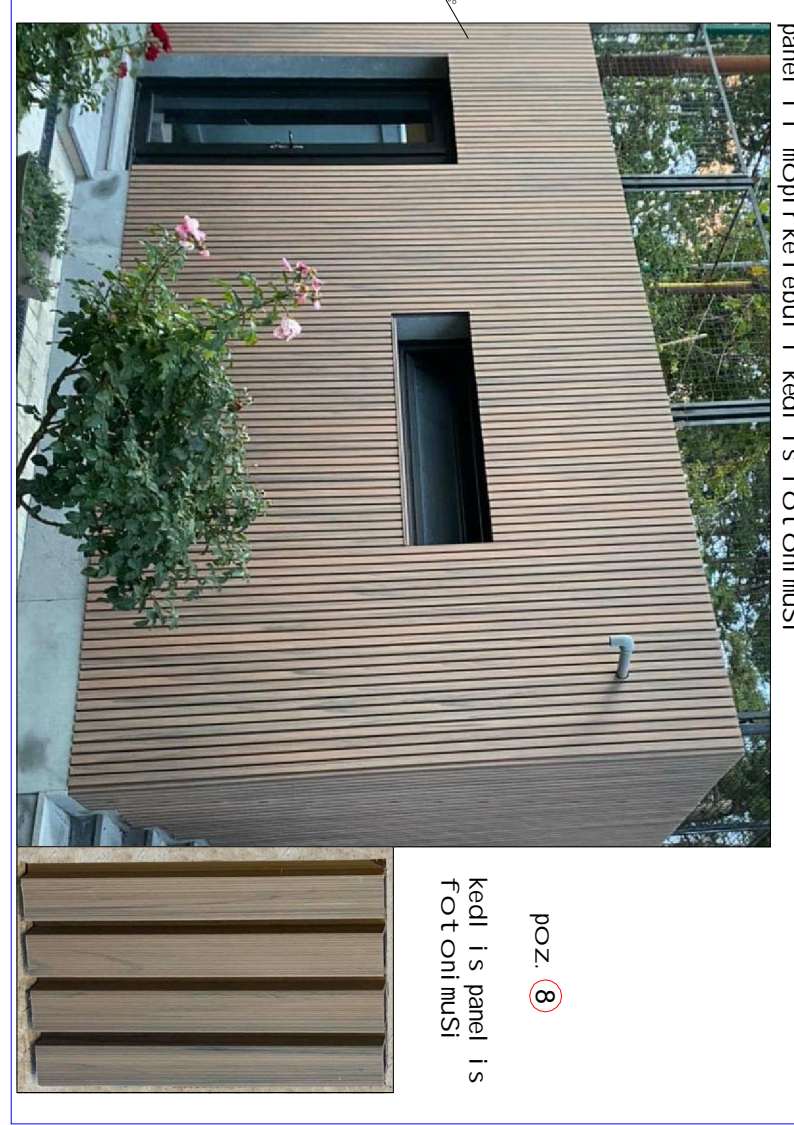

kar-fanj ris eski zeb

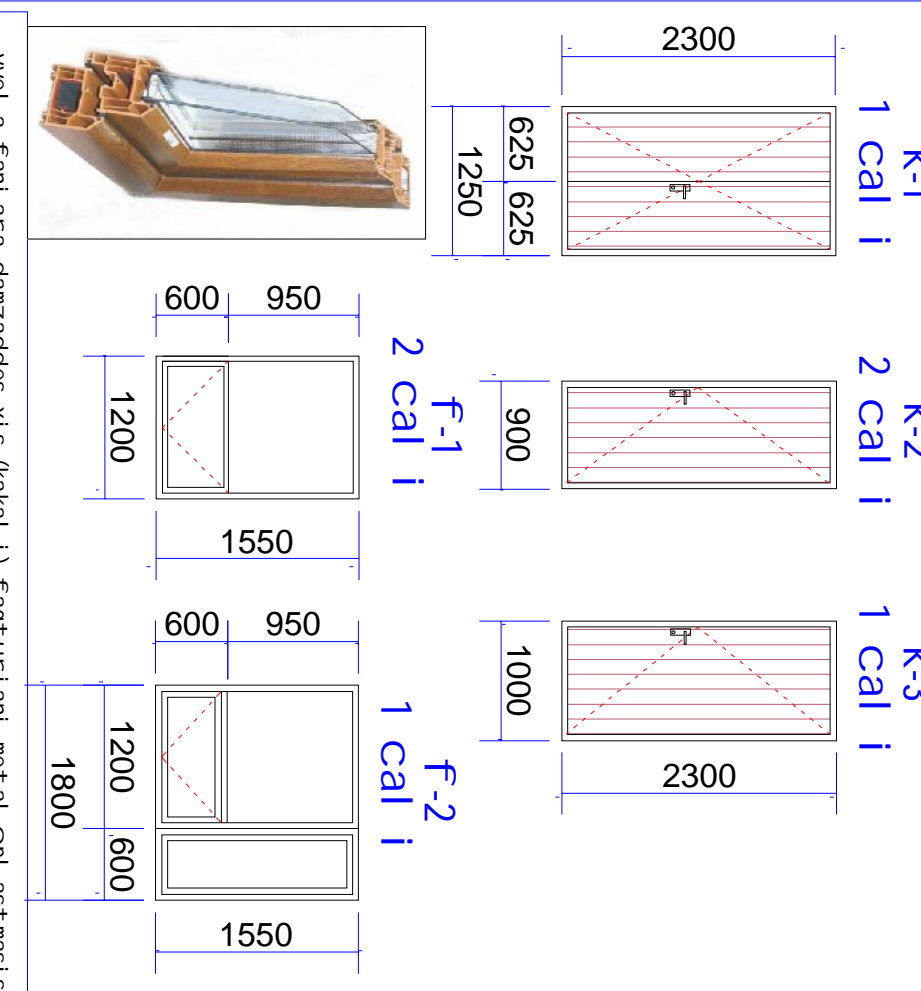
[illegible]

asakeci darabis
fotoni musi



- darabebi danzaddes ornagi akcevi t i t omi s
ConXee, danaghe i kompozituri panel it i gi ve
masal it ri tteC strui ad mopi rket ubi ia Senoba.
ixil e fotomiusl.

- darabS zomebi dazustdes adjl ze.
- aque naCvenebi a gare kedl is gaswritv moxreSl i
saCveneale arxi

[illegible]

sai nformaci o abrebi

— abrebi damzaddes TeTri feris Orgmini s masal i sagan si sge 3-5 m gamoi Wras cal keul i asoebi da damagrdes hermetiki s saSual ebi T.

Kiosk ki oski

[illegible]

In the park are smaller buildings for facilities such as toilets, kiosk and a bin of storage. These buildings are designed as small pavilions in the park style using the material pallet of wood, white signage. The wooden facades of the pavilions blend in the park greenery and sphere.

Building K2 is a kiosk and public toilet building in the zone of the fountain. They are integrated together under one roof of the pavilion. The roof has an overhang to give shadow and shelter for rain. The design of facades of the toilet and kiosk, contains extra attention for its hygiene maintenance. To give the top parts a space for natural ventilation the inside get a breeze and airs the smell out.

K2
zograd, aliteri, oba
par'kš' ar p'ar'era Sanočeti, se'rti, dani, šul, et'is, rogor'icaa
sanočeti: i, tual, et'is, sanzarul, o dani, šul, et'is, o'ra'as, et'
Sanočeti Sanočeti, la rogor'ica p'ar'era par' o'ra' o'ra'et, par' et'is S'i,
s'i, masai, i's ganočeti'et, et, yovul, i've et'rti, sanzar, et, q'os' ar's
mop'ul, i, p'ar' q'm, Sanočeti, et'rti, ar'ous, sanzar, i'et'ad, ar't's
ganočeti, dani, i, p'ar' et' dani, cas, i'z'rti'et, i'v'it'ad, dani, az, i'p'ag, i'v'it' a
et'rti, i'v'it' mop'ul, i' oba, i'v'it' et'is, Sanočeti, i' Sanočeti, i'
f'asaze, i'et'ad, dani, se'rti, Sanočeti, i'v'it' az, i'v'it' dani, i'v'it' f'asaze
(i'et'ad, et'ad, dani, se'rti, Sanočeti, i'v'it' az, i'v'it' dani, i'v'it' f'asaze)
et' emen'et' i' t'ay'ne, et'is, i'va, par'et'is, sanzar, i, rogor'ic, se'rti
dani, par'et'is, masai, i'v'it'ad, adapt'et'et'ad, i'va, S'as, p'ar'at'iv, i'v'it'ad.

Ri Obbebi (Fanji rebi) ara samuSao dr os i xureba i gve masal i s asakeci darabebi T. fasaɗi s mopi reTeEba xi s masal i T, (an xi s faɗu r i ani kompozɪ turl masal i T) harmoni ul ad er'ymni s pa ki s gamvanebas da saer To atmosferos.